

**SHADOW LINE STOPPING ANGLE**

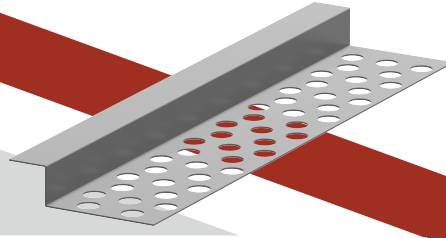

**DESCRIPTION**

Gaccessories™ Shadow Line Stopping Angle corner bead is used for exterior corner jointing. It allows the jointing compound to be fully settled on the jointing area; the compound goes through the bead and strongly fixes the corners to the boards. It is used in suspended ceiling and false ceiling applications.

**MATERIAL PROPERTIES**

Yield Strength (Fy): 33 KSI  
Zinc Coating: G 60- 90

**AVAILABLE THICKNESSES**

0.38 mm

**STANDARD**

Gaccessories™ are manufactured in accordance with ASTM C645 and ASTM A653

**TECHNICAL SPECIFICATIONS**

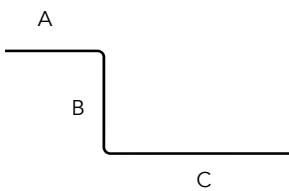

SPECIFICATION	UNIT	VALUE
Material	-	Galvanized steel
Coating	-	Zinc plated
A	mm	16
B	mm	12
C	mm	29
Length	mm	3000
Weight	Kg	0.45
Yield strength	Mpa	280
Tensile strength	Mpa	320

The information herein and recommendations set forth are presented in good faith and believed to be correct as of the date hereof, ASK Gypsum Factory Ltd., and its affiliated, and sister companies do not make representations or warranties as to the completeness or accuracy thereof. Information is supplied upon the condition that the persons receiving the same will make their own determination as to its suitability for their purpose prior to use. In no event will ASK Gypsum Factory Ltd. and its affiliated and sister companies be responsible for indirect, consequential, or incidental damages arising out of the use of, or inability to use this product. Our liability, if any, shall be capped to the price of the product purchased.

All specifications reflect averages derived from product sample testing and are provided as guidance only. They are subject to inherent variances and may be changed without notice to improve reliability, function, or design or otherwise.

Manufactured according to ASTM & EN standards by ASK Gypsum Factory Ltd.